

Courses & Distances

Down River.
 S. 45 E. 78.
 S. 27 E. 52.
 S. 37 E. 44.
 174.

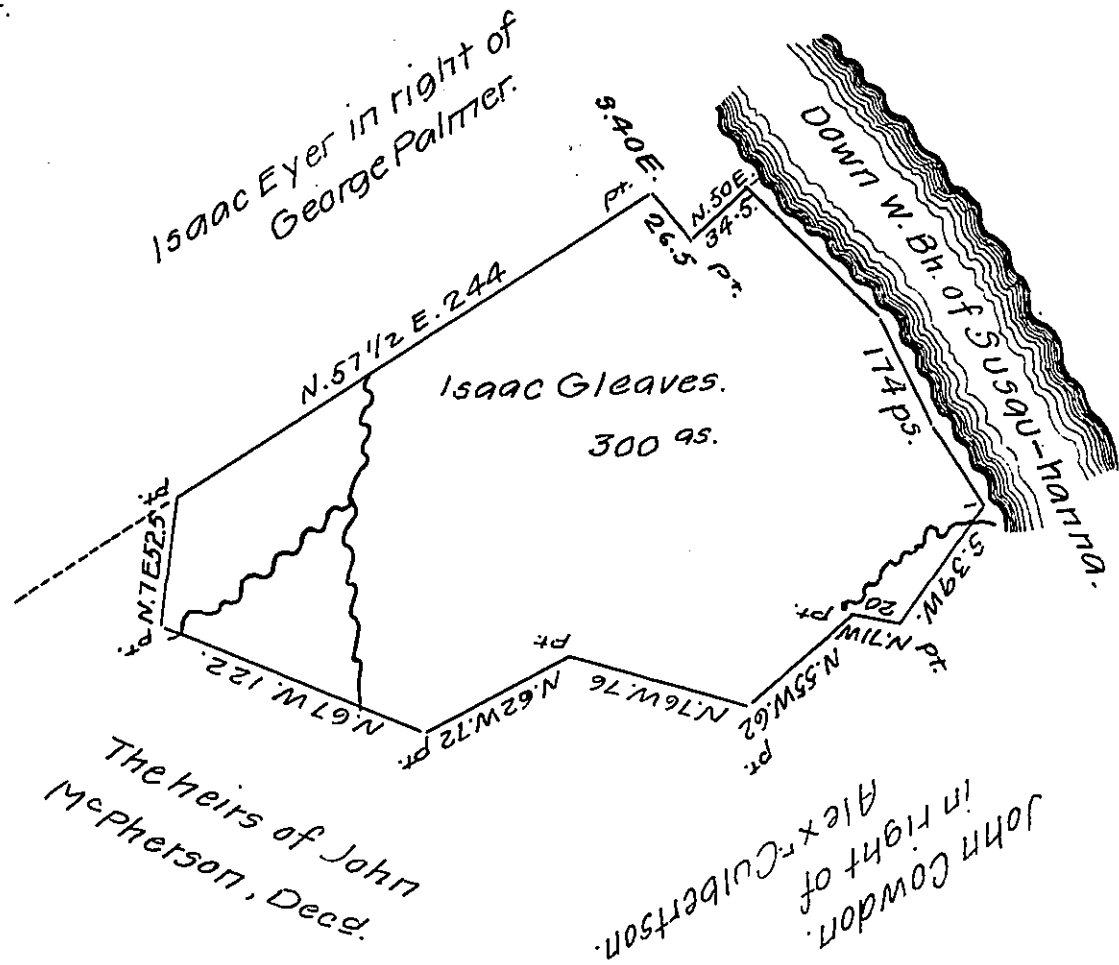

Situate in Buffaloe township Union (late Berks) County Surveyed the 3^d day of May 1833 by virtue of an Order granted to Isaac Gleaves dated the 3^d day of April 1769 N^o 1143 Containing three hundred Acres with the usual Allowance of Six ~~per~~ Cent. & c.

The same tract of land was Surveyed the 4th day of October 1769 for Alexander Craig in pursuance of his Order dated the 3^d day of April 1769 N^o 236 Patent dated the — day of — Granted to — Now owned & in the Possession of John McPherson.

To Jacob Spangler Esq., }
 Surveyor General. }
 J^r. J^r. Hayes.

IN TESTIMONY that the above is a copy of the original remaining on file in the Department of Internal Affairs of Pennsylvania, made conformably to an Act of Assembly approved the 16th day of February, 1833, I have hereunto set my Hand and caused the Seal of said Department to be affixed at Harrisburg, this ninth day of December, 1909.

Henry Hoover
 Secretary of Internal Affairs.